

# NORTH VALLEY LANDFILL CELL 2 LINER INSTALLATION CLARKSTON, UTAH



153 North 1400 West  
Logan, Utah 84321  
(435) 716-9755

CONSULTANTS



ideas for a changing world

2702 South 1030 West, Suite 10  
Salt Lake City, Utah 84119  
(801)270-9400 Fax: (801)270-9401

PROPERTY  
BOUNDARY

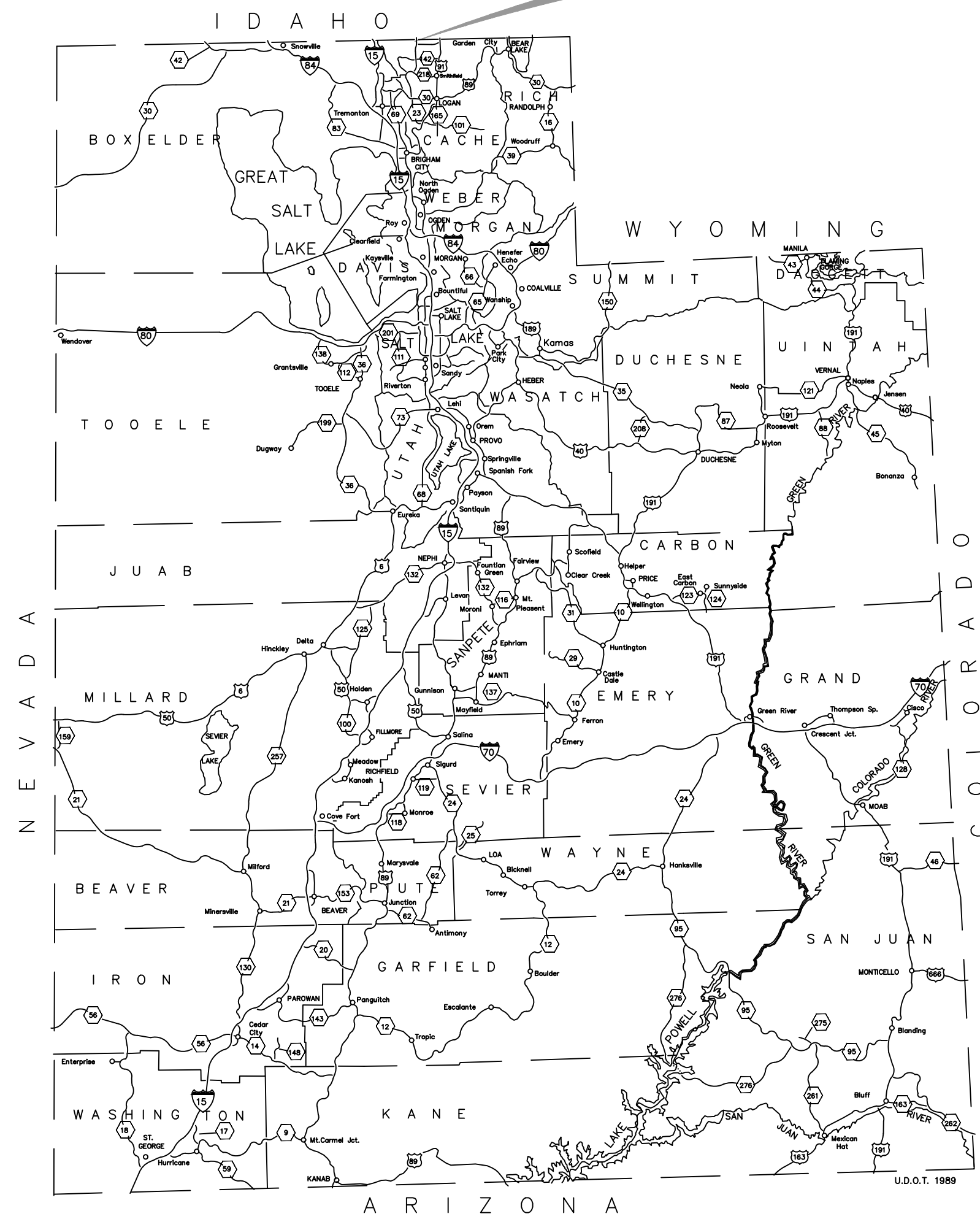

SITE LOCATION MAP

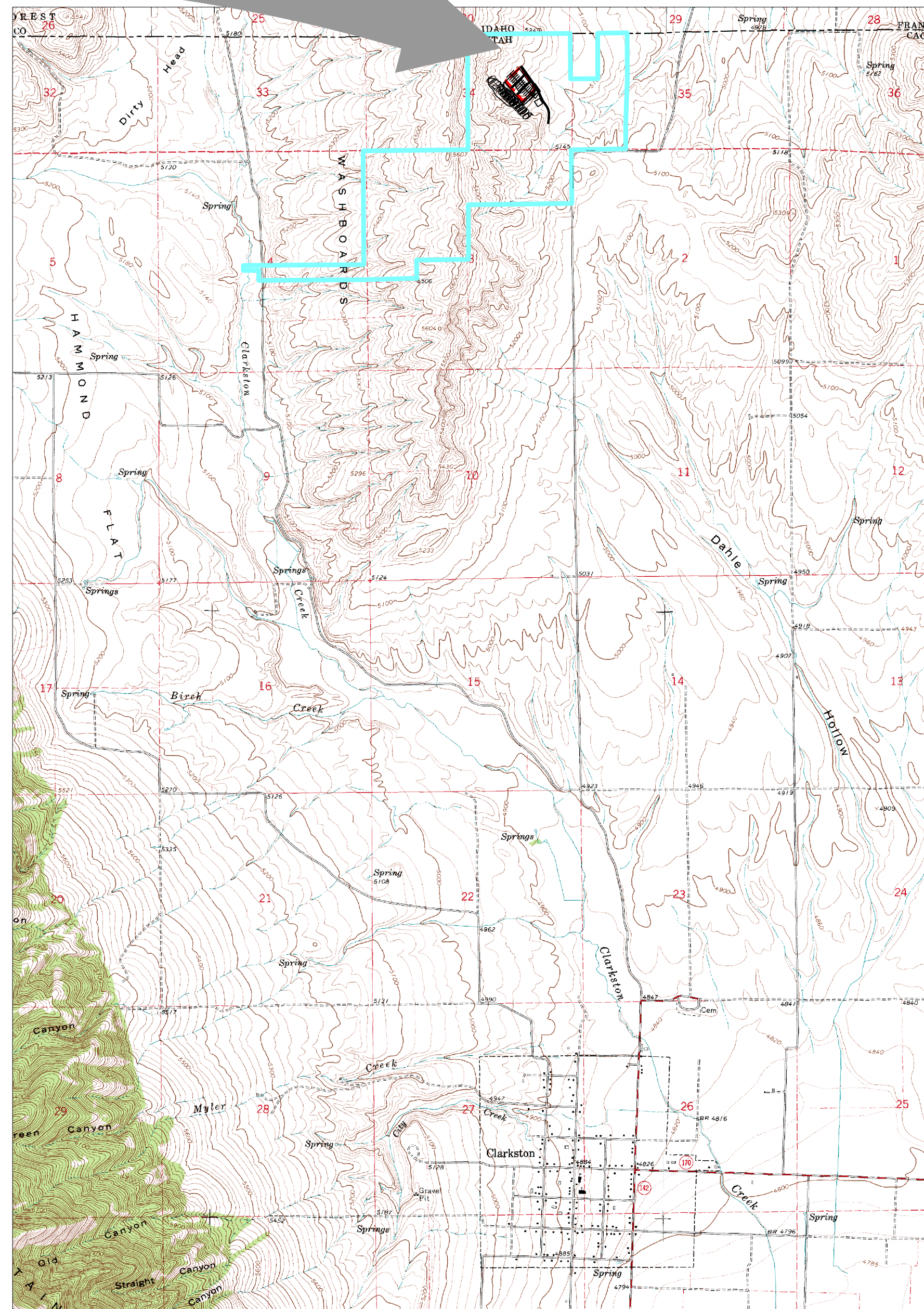

SITE VICINITY MAP  
(1" = 2500')

## DRAWING INDEX

SHEET #	SHEET NAME
1	TITLE SHEET
2	GENERAL ARRANGEMENT
3	CELL PLAN
4	ELEVATION VIEW
5	LINER DETAILS

MARK	DATE	BID SET DESCRIPTION
	6/10/19	BID SET
ISSUE:		
PROJECT NO.:	00386-020	
CAD DWG FILE:	00386\020\Drawings\	
DRAWN BY:	JAH	
DESIGNED BY:	BDM	
CHECKED BY:	TR	
COPYRIGHT:	IGES 2019	

SHEET TITLE  
NVLF - CELL 2 LINER INSTALL  
**TITLE SHEET**



**ISSUED FOR BID**

REFERENCE:  
ADAPTED FROM MAP  
PROVIDED BY CLIENT.



ideas for a changing world

2702 South 1030 West, Suite 10  
Salt Lake City, Utah 84119  
(801)270-9400 Fax: (801)270-9401

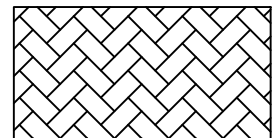
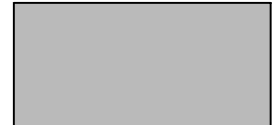
-  PROPERTY BOUNDARY
-  CELL 2 LINER
-  ACCESS ROADS
-  CELL 1 LINER (EXISTING)

1. PLACE DRAIN NET NORTH OF EXISTING ANCHOR TRENCH.
2. RELOCATE ACCESS ROAD ON TOP OF NEW DRAIN NET IN CELL 1. PLACE SLAG.
3. CONTINUE GRADING FROM WEST EDGE OF CELL 2 TO NEW ANCHOR TRENCHES ON EAST AND SOUTH

MARK	DATE	DESCRIPTION
	6/10/19	BID SET

ISSUE:

PROJECT NO.:	00386-020
CAD DWG FILE:	00386\020\DWG\
DRAWN BY:	JAH
DESIGNED BY:	BDM
CHECKED BY:	TR
COPYRIGHT:	IGES 2019

SHEET TITLE  
NVLF - CELL 2 LINER INSTALL  
**GENERAL ARRANGEMENT**



**ISSUED FOR BID**

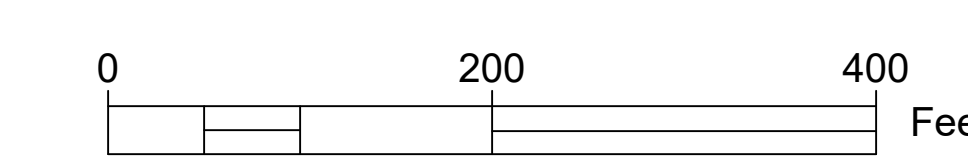

REFERENCE:  
ADAPTED FROM MAP  
PROVIDED BY CLIENT.

CONSULTANTS



ideas for a changing world

2702 South 1030 West, Suite 10  
Salt Lake City, Utah 84119  
(801)270-9400 Fax: (801)270-9401

- PROPERTY BOUNDARY
- 8"Ø PERFORATED HDPE PIPE (EX.)
- 8"Ø PERFORATED HDPE PIPE (NEW)

3. REMOVE BERM/ROAD TO EXPOSE EXISTING LINER ANCHOR TRENCH
4. REMOVE END CAP AND CONNECT TO EXISTING HDPE PIPE
5. REMOVABLE END CAP IS TO BE A BLANK HDPE BOLTED TO HDPE FLANGE WITH 4 BOLTS @ 90°.

MARK	DATE	BID SET DESCRIPTION
	6/10/19	BID SET
ISSUE:		
PROJECT NO.:	00386-020	
CAD DWG FILE:	00386\020\DWG\	
DRAWN BY:	JAH	
DESIGNED BY:	BDM	
CHECKED BY:	TR	
COPYRIGHT:	IGES 2019	

SHEET TITLE  
NVLf - CELL 2 LINER INSTALL  
**CELL PLAN**

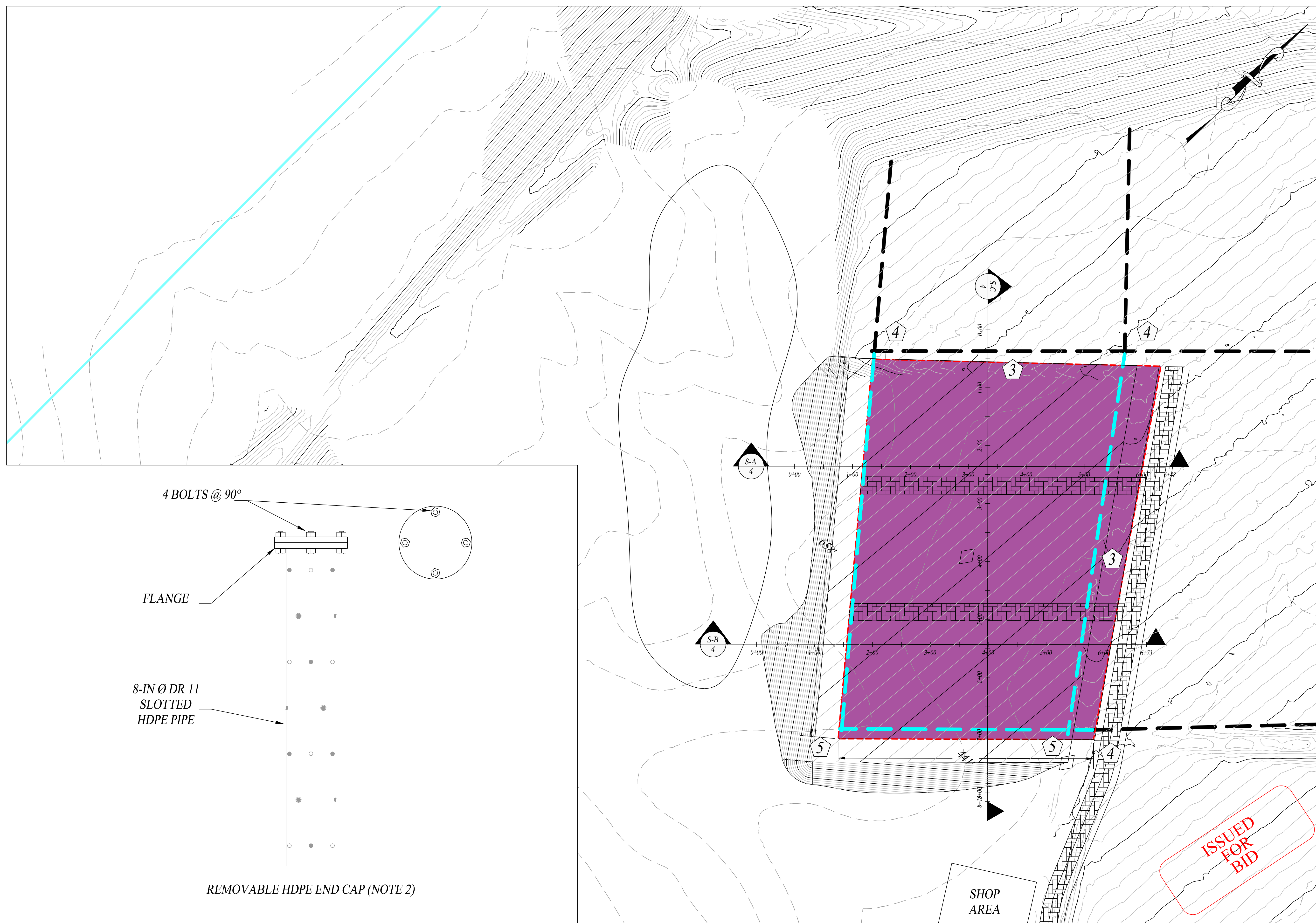

REFERENCE:  
ADAPTED FROM MAP  
PROVIDED BY CLIENT.



ideas for a changing world

2702 South 1030 West, Suite 10  
Salt Lake City, Utah 84119  
(801)270-9400 Fax: (801)270-9401

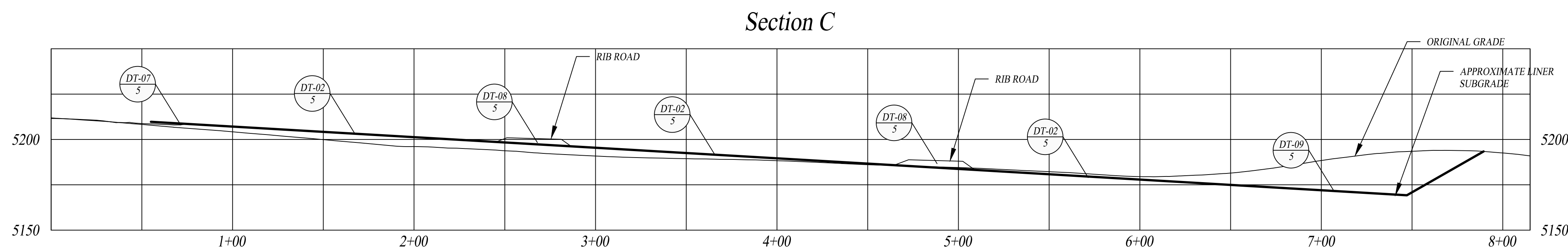
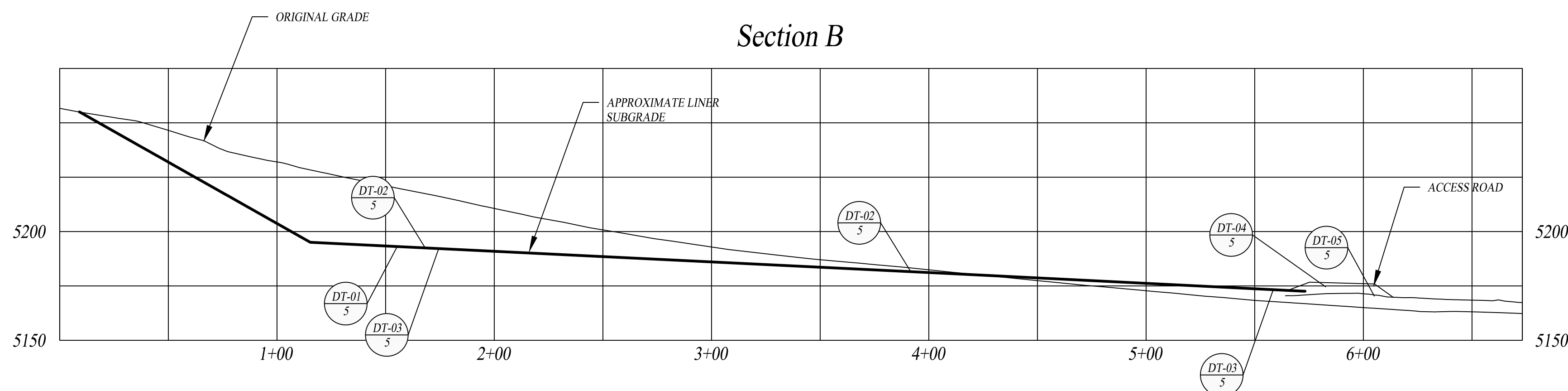
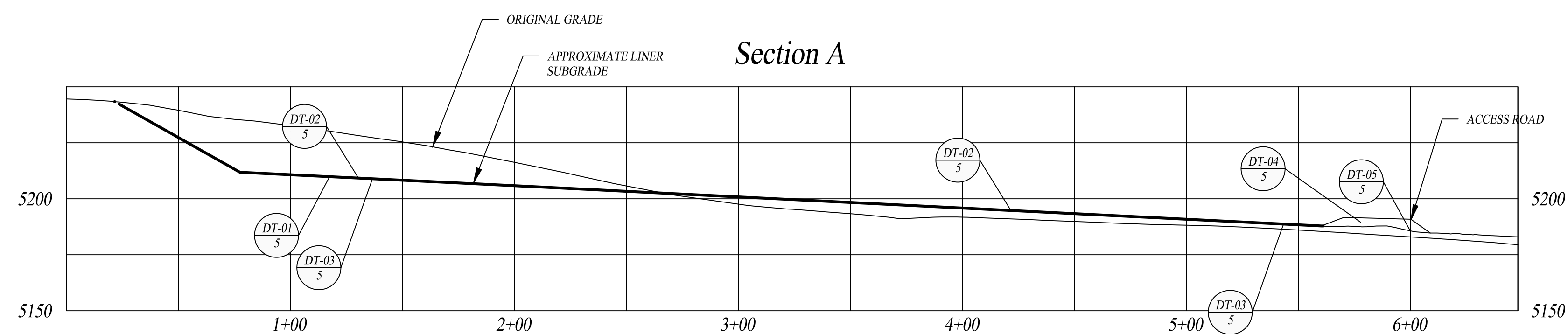

ISSUED FOR BID

REFERENCE:  
ADAPTED FROM MAP  
PROVIDED BY CLIENT.

	6/10/19	BID SET
MARK	DATE	DESCRIPTION
ISSUE:		
PROJECT NO.:	00386-020	
CAD DWG FILE:	00386\020\DWG\	
DRAWN BY:	JAH	
DESIGNED BY:	BDM	
CHECKED BY:	TR	
COPYRIGHT:	IGES 2019	

SHEET TITLE  
NVLf - CELL 2 LINER INSTALL  
**ELEVATION  
VIEW**

CONSULTANTS



ideas for a changing world

2702 South 1030 West, Suite 10  
Salt Lake City, Utah 84119  
(801)270-9400 Fax: (801)270-9401

NOTES:

1. SUBGRADE PREPARATION AND APPROVAL WILL BE RESPONSIBILITY OF CONTRACTOR.
2. GRAVEL BACKFILL TO BE ROUND, HARD, NON-FRIABLE MATERIALS WITH THE FOLLOWING GRADATION

SIEVE SIZE (IN)	% PASSING
1	100
3/4	75
3/8	25
1/4	5

3. REMOVE COVER ROAD SOILS TO EXPOSE EXISTING COMPOSITE LINER (CUT TO SEPARATE FROM ANCHOR TRENCH WHERE APPLICABLE). ROLL BACK UPHILL DRAIN NET, HDPE AND GCL THEN SHINGLE AND CONNECT TO DOWNHILL COMPONENTS IN DIRECTION OF LEACHATE FLOW; DOWNHILL COMPONENTS UNDER UPHILL COMPONENTS AS SHOWN.
4. CONTRACTOR MAY PROPOSE ALTERNATE PERFORMANCE DETAILS IF MANUFACTURER PERFORMANCES ARE AVAILABLE.

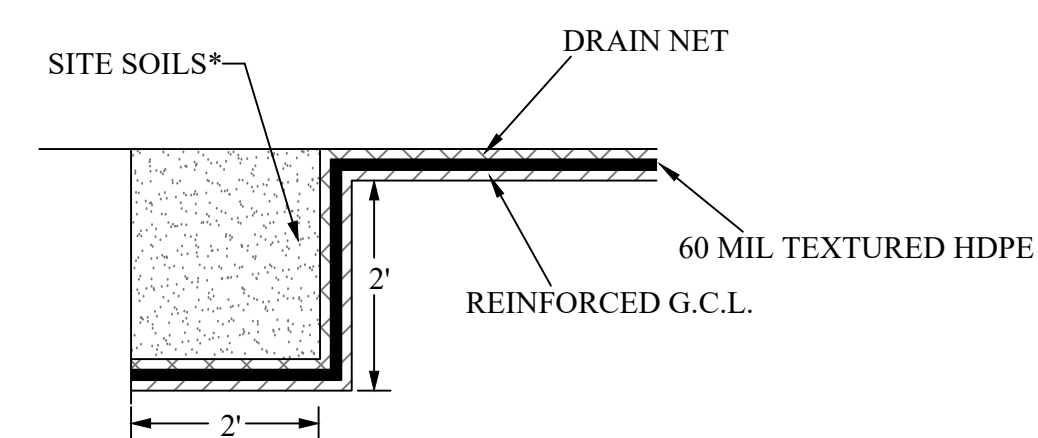

DT-01 ANCHOR TRENCH  
4

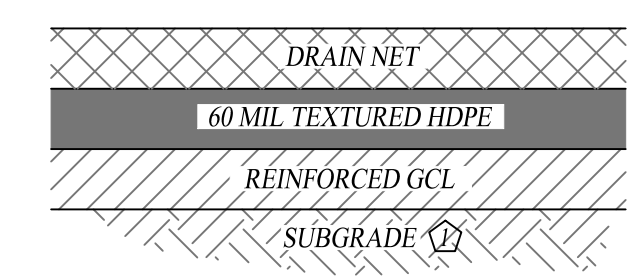

DT-02 COMPOSITE LINER  
4

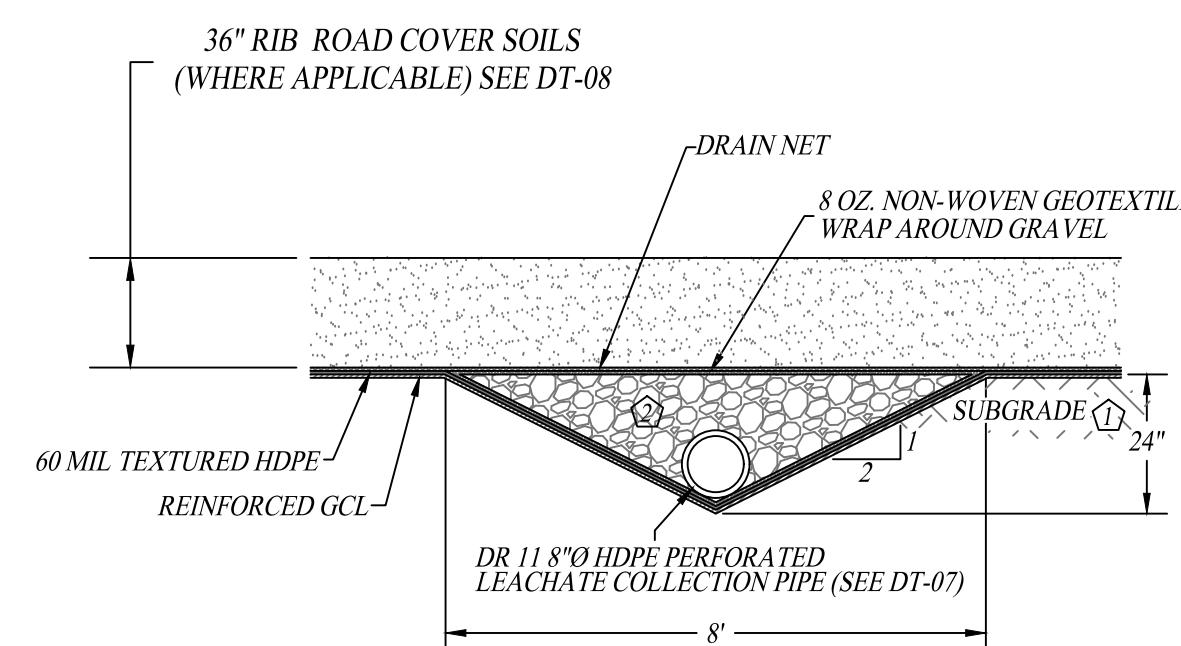

DT-03 LEACHATE COLLECTION PIPE & TRENCH  
4

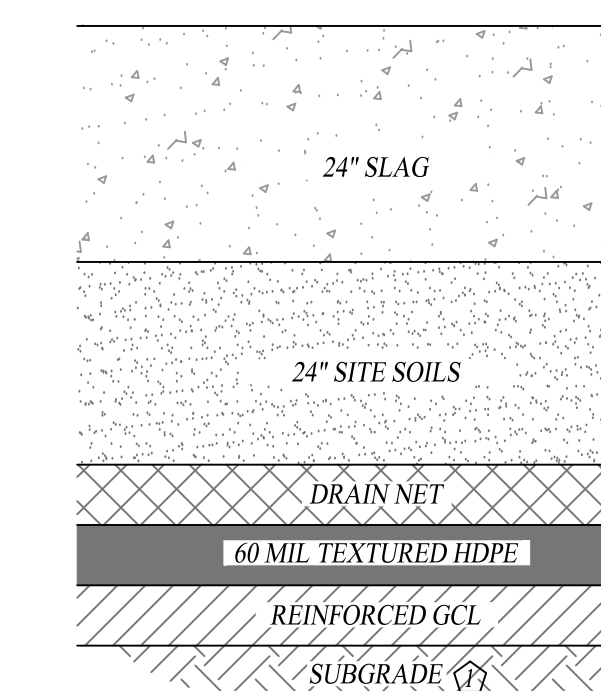

DT-04 COMPOSITE LINER AT ACCESS ROAD  
(GCL/HDPE/DRAIN-NET/SOIL)  
4

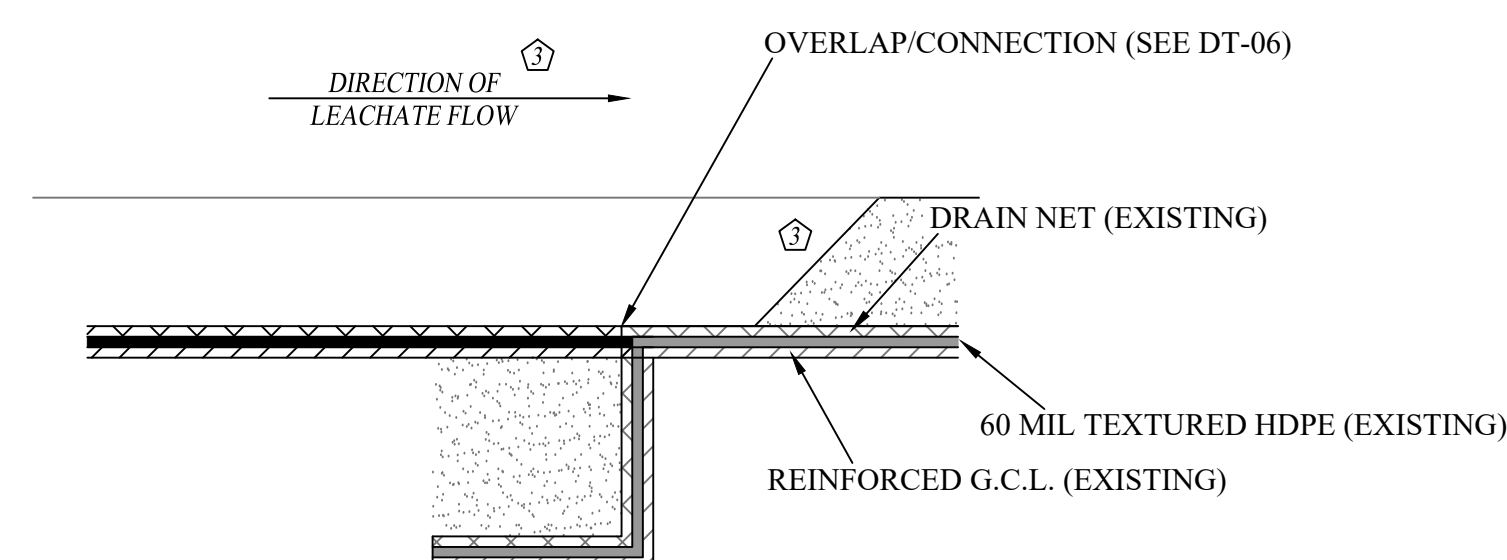

DT-05 ANCHOR TRENCH TIE IN  
4

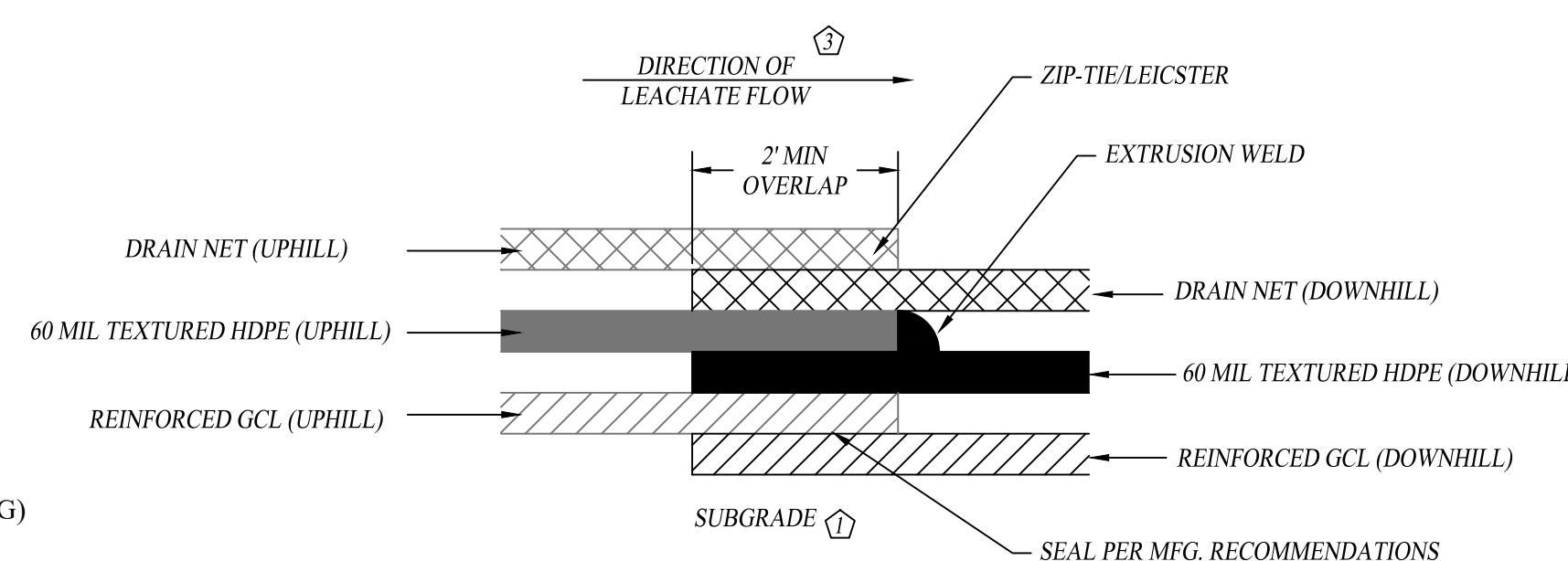

DT-06 EXISTING / NEW LINER CONNECTION  
4

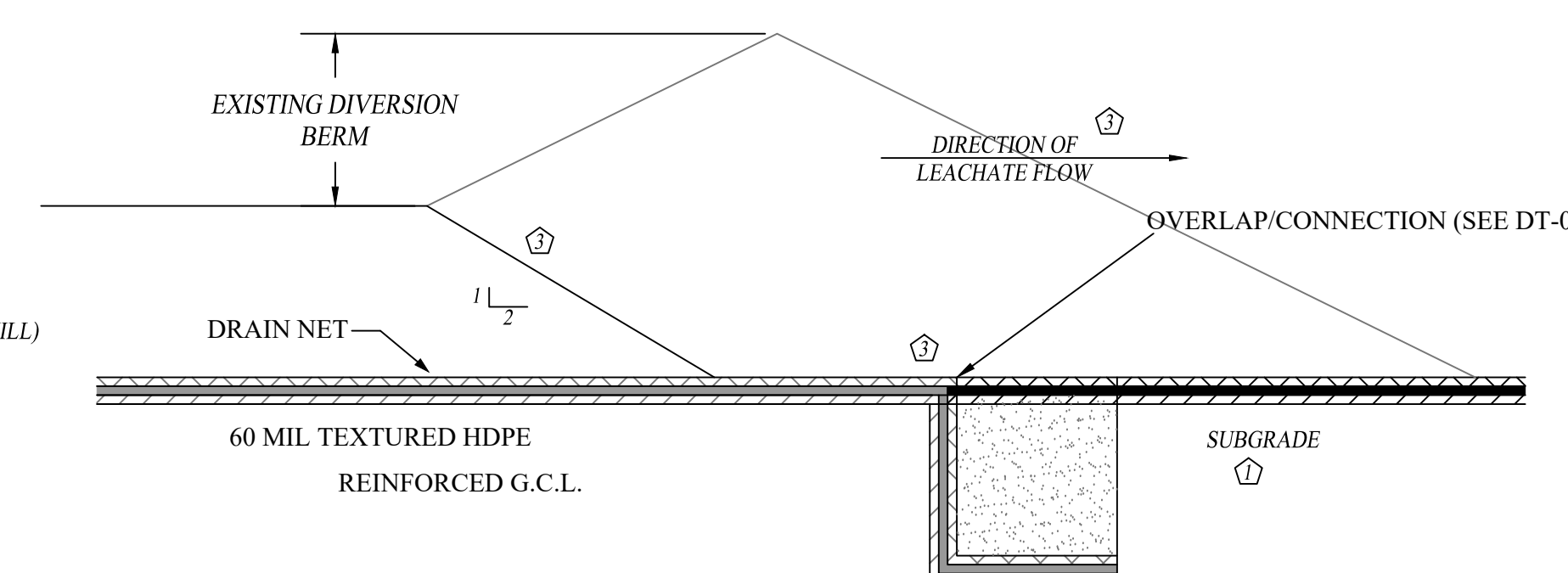

DT-07 LINER CONNECTION  
4

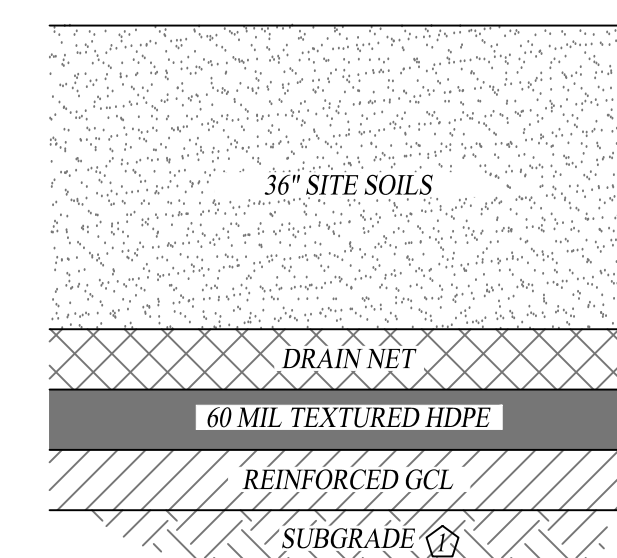

DT-08 COMPOSITE LINER AT RIB ROAD  
(GCL/HDPE/DRAIN-NET/SOIL)  
4

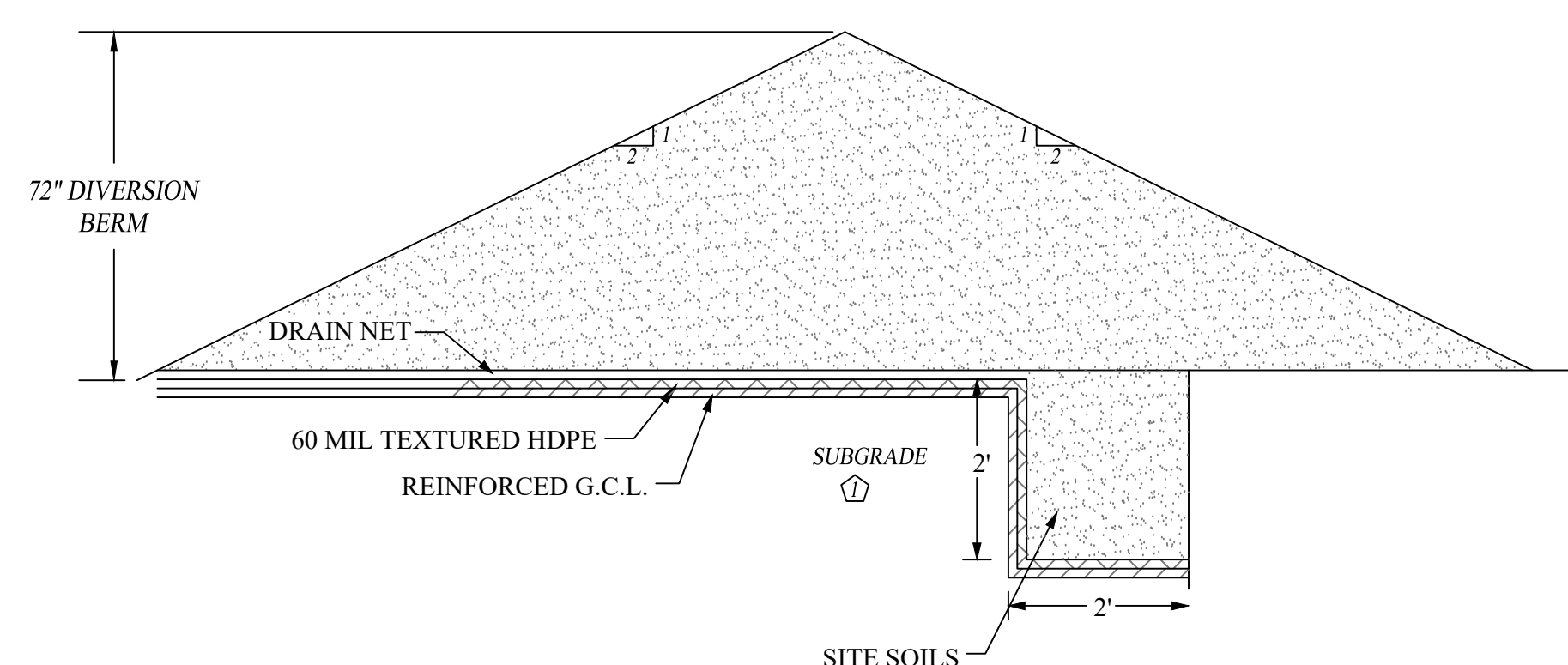

DT-09 LINER TERMINATION IN ANCHOR TRENCH  
5

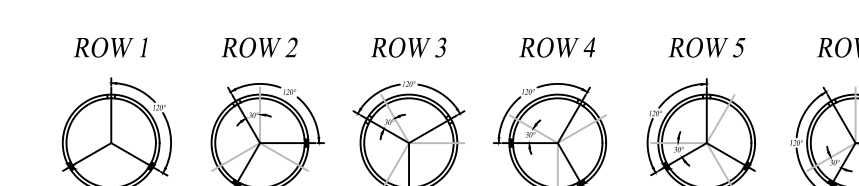

DT-10 PIPE PERFORATION DETAIL  
4

ISSUED FOR BID

REFERENCE:  
ADAPTED FROM MAP  
PROVIDED BY CLIENT.